

eDOCK joystick control

For use with main station or as a standalone control
Add-On to ECS200 & CANBUS control systems



Description

For the ultimate docking control and low speed maneuvering all of the Doen electronic systems can be fitted with Doen's eDOCK joystick control.

eDock co-ordinates the combined control of all waterjets speed setting (engine throttle), steering and reversing to provide a vectored/proportional thrust necessary to move the vessel in the desirable direction with the desirable speed. The eDock panel enables the captain to intuitively maneuver the vessel in any direction pointed by the single joystick and/or control the yaw by twisting it.

Features

- **CAN BUS** technology; fully programmable
- Single control box enclosure housing CPU unit
- Plug in cabling using Deutsch Connectors.
- Multi axis joystick providing lateral vessel control with twist knob for yaw correction.
- Add-On technology – integrates with all standard DOEN electronic controls to provide joystick docking feature
- Simple setup and calibration
- Configurable input / output

Options

- Available (configurable) as joystick panel adjacent to the main station or as a standalone device - a separate docking station
- Bow thruster interface
- Complies to Class



System Configuration Twin Jet, Remote Station Depicted

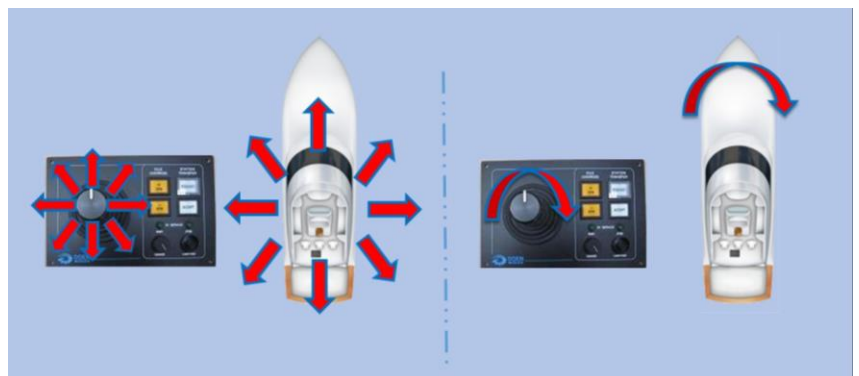
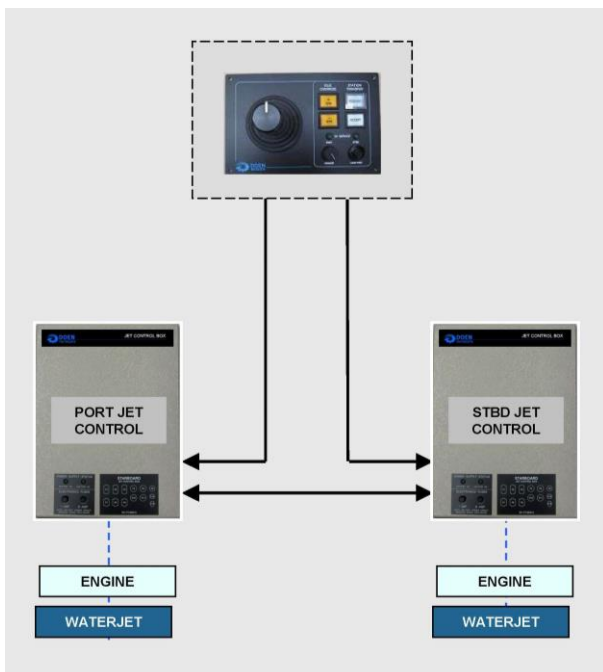

DOEN WATERJETS

33 VENTURE WAY, BRAESIDE, 3195
VICTORIA, AUSTRALIA

TEL: + 613 9587 3944
FAX: + 613 9587 3179

Email: inquiries@doen.com
Web: www.doen.com

